

GATED CONDOMINIUM STORAGE COMMUNITY

www.thestableslakecity.com

1-651-345-1200

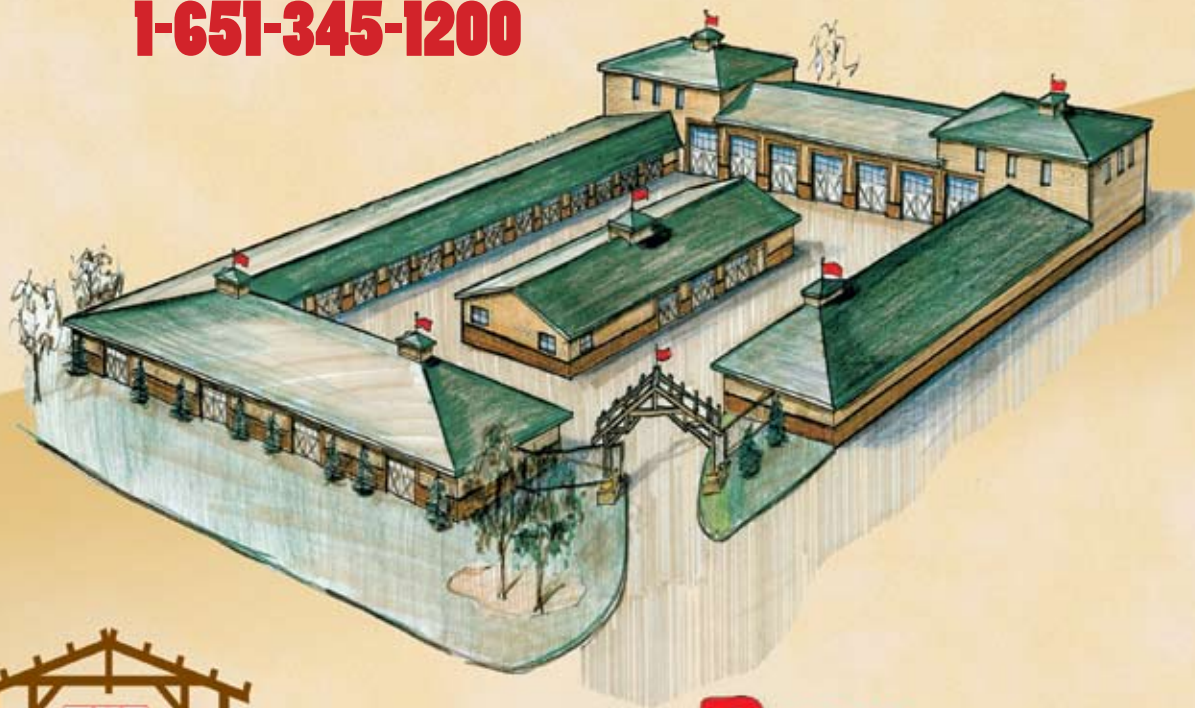

**Buy
yours today!**

**New Concept
In Recreation!**

Condo Storage Facility for your Toys, Boats, RVs, Snowmobiles, Motorcycles, Collector Cars, and more!

Units may be upgraded to include heat, air conditioning, and professional design packages.

Owners have unrestricted use of community room which includes showers, wet bar and gathering area. A great place to relax after a day on Lake Pepin.

24/7 access gated community with fully monitored security system. There are a variety of storage sizes to choose from.

FOR YOUR CONVENIENCE...

Adjoining is a new Self Service and Automatic ~ Auto, Boat, RV and Pet Wash facility with an RV dump station.

*Sign up for our
Washcard program!*



Visit us online at:

www.thestableslakecity.com

For more information.

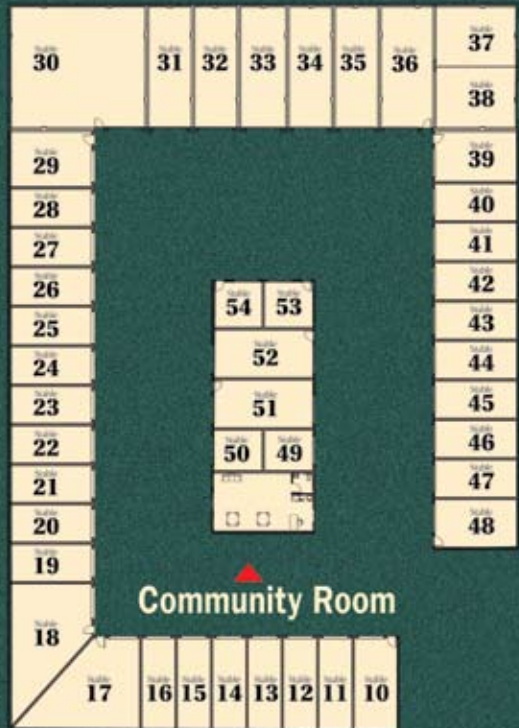

Pet Wash, Autos, Trucks & RV Wash

PRSR STD
 US POSTAGE PAID
 LAKE CITY, MN
 PERMIT NO. 26

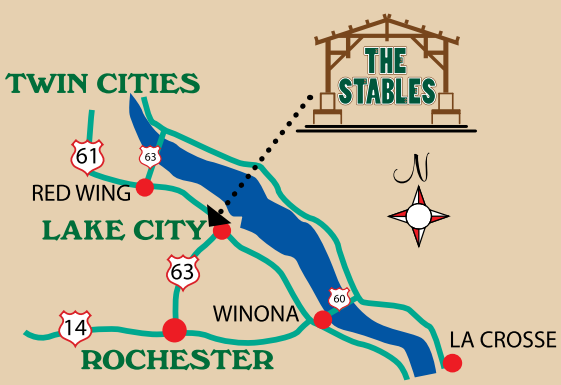

Directions:
 Lake City is located in Southeastern Minnesota along the Mississippi River on Lake Pepin. Approximately 35 miles Northeast of Rochester and 65 miles Southeast of the Twin Cities.

THE STABLES
 1235 N. 7TH ST.
 LAKE CITY, MN 55041

Gated Condominium Storage Community



Restricted - Residential Recreational User

- LUXURY CONDOMINIUM STORAGE UNITS
- COMMUNITY ROOM
- SECURITY 24/7
- AUTOMATIC DOORS
- LARGE VARIETY OF SIZES AND OPTIONS AVAILABLE

1-651-345-1200

www.thestableslakecity.com

1235 N. 7TH ST. • LAKE CITY, MN 55041